

ALDRH Series



FEATURES

- ◆ Low DC resistance and for large current.
- ◆ Closed magnetic circuit crosstalk.
- ◆ Excellent solderability and heat resistance.
- ◆ Available for automatic mounting in tape and reel package.

APPLICATIONS

- ◆ Ideally used in Power supply for VTR, OA equipment, Digital camera, LCD television set notebook PC, etc as DC-DC Converter.

PRODUCT IDENTIFICATION

ALDRH- 7032- 100 M

a b c d

a: Series name

b: Product dimensions (a x c)

c: Inductance Value(1R0:1.0uH; 100: 10uH; 101:100uH)

d: Inductance Tolerance (K:10% ; M:20% ; N:30%)

SHAPES AND DIMENSIONS

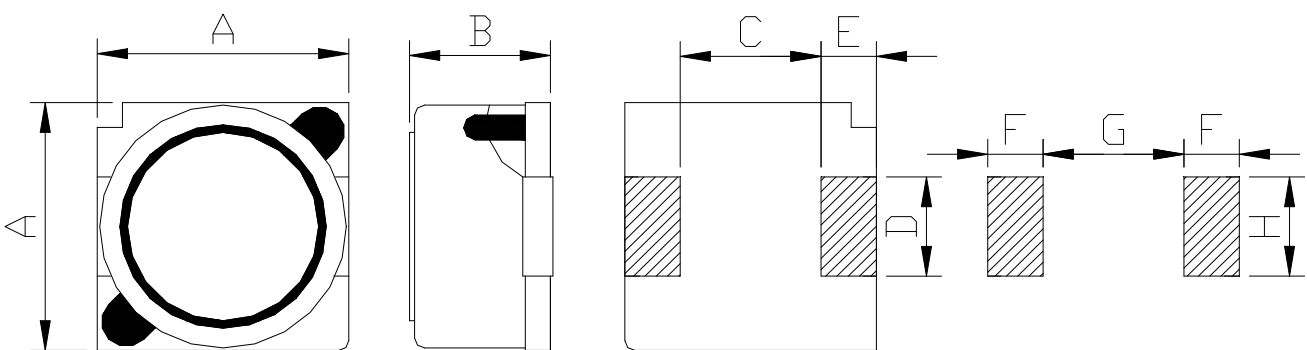

ALDRH Series

SHAPES AND DIMENSIONS

Series	Dimensions(mm)							
	A	B Max .	C	D	E	F Ref.	G Ref.	H Ref.
ALDRH-6028	6.0±0.3	3.10	4.0±0.2	2.0±0.2	0.9	1.5	4.0	2.2
ALDRH-6045	6.0±0.3	4.80	4.0±0.2	2.0±0.2	0.9	1.5	4.0	2.2
ALDRH-7032	7.0±0.3	3.50	4.9±0.2	2.0±0.2	0.9	1.5	4.9	2.2
ALDRH-7045	7.0±0.3	4.80	4.9±0.2	2.0±0.2	0.9	1.5	4.9	2.2
ALDRH-7055	7.0±0.3	5.80	4.9±0.2	2.0±0.2	0.9	1.5	4.9	2.2
ALDRH-10145	10.1±0.3	4.80	6.0±0.2	3.0±0.2	2.0	2.5	5.6	3.2
ALDRH-12555	12.5±0.3	5.80	8.0±0.2	3.0±0.2	2.0	2.5	8.6	3.2
ALDRH-12565	12.5±0.3	6.90	8.0±0.2	3.0±0.2	2.0	2.5	8.6	3.2
ALDRH-12575	12.5±0.3	7.90	8.0±0.2	3.0±0.2	2.0	2.5	8.6	3.2

ALDRH-6028 Series ELECTRICAL CHARACTERISTICS

Part Number	L (uH)	Test Freq. (KHz/V)	DCR Max. (Ω)	IDC Max. (A)
ALDRH-6028-4R7N	4.7	100/0.25	0.034	1.60
ALDRH-6028-6R8N	6.8	100/0.25	0.043	1.50
ALDRH-6028-100M	10	100/0.25	0.064	1.30
ALDRH-6028-150M	15	100/0.25	0.090	1.00
ALDRH-6028-220M	22	100/0.25	0.125	0.77
ALDRH-6028-330M	33	100/0.25	0.178	0.69
ALDRH-6028-470M	47	100/0.25	0.252	0.59
ALDRH-6028-680M	68	100/0.25	0.348	0.50
ALDRH-6028-101M	100	100/0.25	0.516	0.42
ALDRH-6028-151M	150	100/0.25	0.780	0.34
ALDRH-6028-221M	220	100/0.25	1.176	0.26

Note:

1.Tolerance: N:±30% , M:±20% , K:±10%

2.IDC:DC current at which the inductance drops approximate 30% from its value without current;

ALDRH-6045 Series ELECTRICAL CHARACTERISTICS

Part Number	L (μ H)	Test Freq. (KHz/V)	DCR Max. (Ω)	IDC Max. (A)
ALDRH-6045-1R0N	1.0	100/0.25	0.023	2.70
ALDRH-6045-1R5N	1.5	100/0.25	0.026	2.30
ALDRH-6045-2R2N	2.2	100/0.25	0.028	1.90
ALDRH-6045-3R3N	3.3	100/0.25	0.035	1.80
ALDRH-6045-4R7N	4.7	100/0.25	0.040	1.40
ALDRH-6045-6R8N	6.8	100/0.25	0.045	1.20
ALDRH-6045-100M	10	100/0.25	0.060	1.00
ALDRH-6045-150M	15	100/0.25	0.070	0.80
ALDRH-6045-220M	22	100/0.25	0.110	0.65
ALDRH-6045-330M	33	100/0.25	0.165	0.55
ALDRH-6045-470M	47	100/0.25	0.210	0.45
ALDRH-6045-680M	68	100/0.25	0.285	0.37
ALDRH-6045-101M	100	100/0.25	0.420	0.30
ALDRH-6045-151M	150	100/0.25	0.630	0.25
ALDRH-6045-181M	180	100/0.25	0.720	0.22
ALDRH-6045-221M	220	100/0.25	0.820	0.20
ALDRH-6045-271M	270	100/0.25	1.100	0.18
ALDRH-6045-331M	330	100/0.25	1.200	0.17
ALDRH-6045-391M	390	100/0.25	1.700	0.16
ALDRH-6045-471M	470	100/0.25	1.900	0.14
ALDRH-6045-561M	560	100/0.25	2.150	0.13
ALDRH-6045-681M	680	100/0.25	3.300	0.12
ALDRH-6045-821M	820	100/0.25	3.650	0.11

Note:

1.Tolerance: N: \pm 30% , M: \pm 20% , K: \pm 10%

2.IDC:DC current at which the inductance drops approximate 30% from its value without current;



ALDRH-7032/7045 Series ELECTRICAL CHARACTERISTICS

Part Number	L (uH)	Test Freq. (KHz/V)	DCR Max. (Ω)	IDC Max. (A)
ALDRH-7032-3R3N	3.3	100/0.25	0.028	1.90
ALDRH-7032-4R7N	4.7	100/0.25	0.044	1.70
ALDRH-7032-6R8N	6.8	100/0.25	0.050	1.60
ALDRH-7032-100M	10	100/0.25	0.064	1.40
ALDRH-7032-150M	15	100/0.25	0.090	1.10
ALDRH-7032-220M	22	100/0.25	0.132	0.96
ALDRH-7032-330M	33	100/0.25	0.192	0.75
ALDRH-7032-470M	47	100/0.25	0.288	0.67
ALDRH-7032-680M	68	100/0.25	0.372	0.59
ALDRH-7032-101M	100	100/0.25	0.540	0.45
ALDRH-7032-151M	150	100/0.25	0.780	0.37
ALDRH-7032-221M	220	100/0.25	1.260	0.29
ALDRH-7032-331M	330	100/0.25	2.000	0.22
ALDRH-7032-471M	470	100/0.25	2.460	0.20
ALDRH-7032-681M	680	100/0.25	3.780	0.16
ALDRH-7032-102M	1000	100/0.25	5.730	0.13

Part Number	L (uH)	Test Freq. (KHz/V)	DCR Max. (Ω)	IDC Max. (A)
ALDRH-7045-3R3N	3.3	100/0.25	0.024	2.50
ALDRH-7045-4R7N	4.7	100/0.25	0.036	2.00
ALDRH-7045-6R8N	6.8	100/0.25	0.047	1.70
ALDRH-7045-100M	10	100/0.25	0.056	1.30
ALDRH-7045-150M	15	100/0.25	0.063	1.10
ALDRH-7045-220M	22	100/0.25	0.074	0.90
ALDRH-7045-330M	33	100/0.25	0.116	0.82
ALDRH-7045-470M	47	100/0.25	0.150	0.75
ALDRH-7045-680M	68	100/0.25	0.210	0.60
ALDRH-7045-101M	100	100/0.25	0.300	0.50
ALDRH-7045-151M	150	100/0.25	0.408	0.40
ALDRH-7045-221M	220	100/0.25	0.624	0.33
ALDRH-7045-331M	330	100/0.25	0.888	0.25
ALDRH-7045-471M	470	100/0.25	1.260	0.22
ALDRH-7045-681M	680	100/0.25	1.776	0.20
ALDRH-7045-102M	1000	100/0.25	2.736	0.14

Note:

- 1.Tolerance: N:±30% , M:±20% , K:±10%
- 2.IDC:DC current at which the inductance drops approximate 30% from its value without current;

ALDRH-7055/10145 Series ELECTRICAL CHARACTERISTICS

Part Number	L (μ H)	Test Freq. (KHz/V)	DCR Max. (Ω)	IDC Max. (A)
ALDRH-7055-1R5N	1.5	100/0.25	0.023	6.20
ALDRH-7055-2R2N	2.2	100/0.25	0.029	5.30
ALDRH-7055-3R3N	3.3	100/0.25	0.032	4.30
ALDRH-7055-3R9N	3.9	100/0.25	0.034	4.00
ALDRH-7055-4R7N	4.7	100/0.25	0.037	3.60
ALDRH-7055-6R8N	6.8	100/0.25	0.045	3.00
ALDRH-7055-100M	10	100/0.25	0.051	2.60
ALDRH-7055-150M	15	100/0.25	0.067	2.10
ALDRH-7055-180M	18	100/0.25	0.074	1.90
ALDRH-7055-220M	22	100/0.25	0.084	1.70
ALDRH-7055-330M	33	100/0.25	0.114	1.40
ALDRH-7055-470M	47	100/0.25	0.169	1.20
ALDRH-7055-680M	68	100/0.25	0.260	0.90
ALDRH-7055-101M	100	100/0.25	0.381	0.80

Part Number	L (μ H)	Test Freq. (KHz/V)	DCR Max. (Ω)	IDC Max. (A)
ALDRH-10145-3R3N	3.3	100/0.25	0.020	4.90
ALDRH-10145-5R6N	5.6	100/0.25	0.027	3.80
ALDRH-10145-100M	10	100/0.25	0.044	3.00
ALDRH-10145-150M	15	100/0.25	0.057	2.40
ALDRH-10145-220M	22	100/0.25	0.071	2.10
ALDRH-10145-330M	33	100/0.25	0.099	1.60
ALDRH-10145-470M	47	100/0.25	0.120	1.40
ALDRH-10145-680M	68	100/0.25	0.168	1.20
ALDRH-10145-101M	100	100/0.25	0.240	1.00
ALDRH-10145-151M	150	100/0.25	0.420	0.79
ALDRH-10145-221M	220	100/0.25	0.564	0.65
ALDRH-10145-331M	330	100/0.25	0.816	0.54
ALDRH-10145-471M	470	100/0.25	1.236	0.47
ALDRH-10145-681M	680	100/0.25	1.920	0.38
ALDRH-10145-102M	1000	100/0.25	3.360	0.32
ALDRH-10145-152M	1500	100/0.25	4.080	0.22

Note:

- 1.Tolerance: N: \pm 30% , M: \pm 20% , K: \pm 10%
- 2.IDC:DC current at which the inductance drops approximate 30% from its value without current;

ALDRH-12555/12565/12575 Series ELECTRICAL CHARACTERISTICS

Part Number	L (uH)	Test Freq. (KHz/V)	DCR Max. (Ω)	IDC Max. (A)
ALDRH-12555-6R0N	6.0	100/0.25	0.020	3.60
ALDRH-12555-100M	10	100/0.25	0.026	3.40
ALDRH-12555-150M	15	100/0.25	0.032	2.80
ALDRH-12555-220M	22	100/0.25	0.041	2.30
ALDRH-12555-330M	33	100/0.25	0.050	1.90
ALDRH-12555-470M	47	100/0.25	0.075	1.60
ALDRH-12555-680M	68	100/0.25	0.100	1.30
ALDRH-12555-101M	100	100/0.25	0.141	1.10
ALDRH-12555-151M	150	100/0.25	0.228	0.88
ALDRH-12555-221M	220	100/0.25	0.324	0.72
ALDRH-12555-331M	330	100/0.25	0.492	0.59
ALDRH-12555-471M	470	100/0.25	0.624	0.49
ALDRH-12555-681M	680	100/0.25	0.912	0.43

Part Number	L (uH)	Test Freq. (KHz/V)	DCR Max. (Ω)	IDC Max. (A)
ALDRH-12565-2R0N	2.0	100/0.25	0.015	10.00
ALDRH-12565-100M	10	100/0.25	0.025	5.00
ALDRH-12565-150M	15	100/0.25	0.029	4.20
ALDRH-12565-220M	22	100/0.25	0.038	3.50
ALDRH-12565-330M	33	100/0.25	0.049	2.80
ALDRH-12565-470M	47	100/0.25	0.070	2.40
ALDRH-12565-680M	68	100/0.25	0.095	2.00
ALDRH-12565-101M	100	100/0.25	0.148	1.60

Part Number	L (uH)	Test Freq. (KHz/V)	DCR Max. (Ω)	IDC Max. (A)
ALDRH-12575-1R2N	1.2	100/0.25	0.009	13.00
ALDRH-12575-6R8N	6.8	100/0.25	0.016	7.20
ALDRH-12575-100M	10	100/0.25	0.019	5.50
ALDRH-12575-220M	22	100/0.25	0.032	4.00
ALDRH-12575-330M	33	100/0.25	0.048	3.20
ALDRH-12575-470M	47	100/0.25	0.064	2.70
ALDRH-12575-680M	68	100/0.25	0.094	2.00
ALDRH-12575-101M	100	100/0.25	0.150	1.90
ALDRH-12575-221M	220	100/0.25	0.310	1.30

Note:

- 1.Tolerance: N:±30% , M:±20% , K:±10%
- 2.IDC:DC current at which the inductance drops approximate 30% from its value without current;